

AWAS

Emulsion Splitting Plant



treating



AWAS-CH batch system
CH-600 with special accessories

Problem

- heavily polluted effluents
- strong emulsions
- varying pH-values
- varying organic load

Pollutants

- oil and grease emulsions
- heavy metals
- detergents
- wax, silicone
- phosphate
- paint
- graphite
- rubber, plastic, metal abrasion

AWAS Solution

The effluent is mechanically pre-cleaned in patented an AWAS High Performance Separator. From a buffer tank the waste water is pumped into the AWAS-CH batch system. It is cracked and neutralised. The purified water is discharged to the sewage plant. The sludge will be drained in an adequate sludge treatment system.

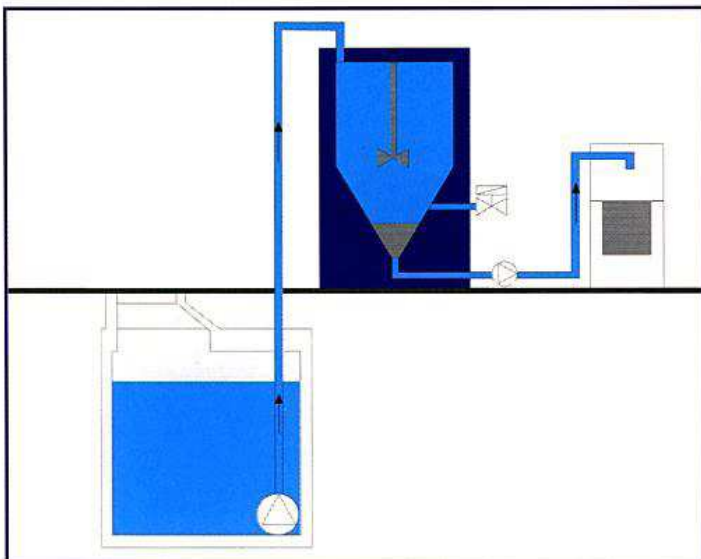

Emulsion buffer tank and AWAS-CH batch system

Specific Advantages of the AWAS-CH Batch System

Save money

- by the use of liquid chemicals
 - little sludge
 - little disposal cost
- incorporated pH-neutralisation
 - neutral pH value of water and sludge
 - reduced disposal cost
- thoroughly selected chemicals
 - perfect purification efficiency
 - low chemical consumption
- made of PE/PP/PVC
 - our lightweight champion
 - no corrosion
 - recyclable materials
- compact design
 - little space requirement
 - ease of upgrading
- adjustable process parameters
 - access to PLC control
 - copes with varying effluents
- sludge conditioning
 - compact sludge, low disposal cost
- optional: addition of adsorbents
 - reduction of solvents, AOHC, PAHC
- flow from 300 l/h – 2000 l/h
- for larger output ask for our flotation plants AWAS-FLOT

Application

work shops, tanneries, metal treatment, paint shops, chemical industry, composting, foodstuff industry, aluminium and magnesium die casting, leachate, furniture production and others



AWAS GmbH Bayern

Tölzer Straße 65
 82041 Oberhaching
 Germany
 Tel. +49 (0)89 613 56 67
 Fax +49 (0)89 613 57 67
 info@awas-bayern.de
 www.awas-bayern.de

AGENT: